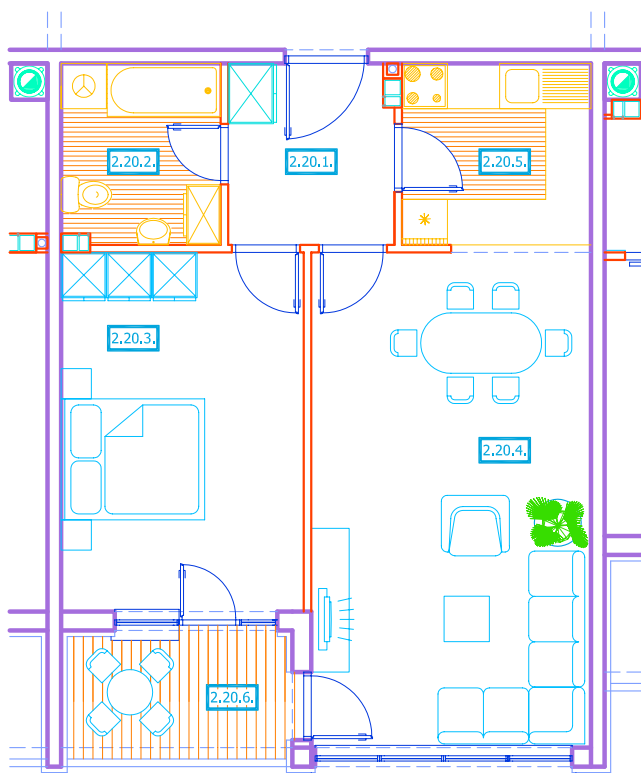

## 1. KAT - STAN 20

2.20.1.	hodnik	pp
	5,19 m <sup>2</sup>	
2.20.2.	kupaonica	pkp
	5,00 m <sup>2</sup>	
2.20.3.	soba	pp
	15,25 m <sup>2</sup>	
2.20.4.	boravak i blagovanje	pp
	24,24 m <sup>2</sup>	
2.20.5.	kuhinja	pkp
	6,00 m <sup>2</sup>	
2.20.6.	loggia	pkp
	4,70 x 0,75 = 3,53 m <sup>2</sup>	

UKUPNO NETTO : 59,21 M<sup>2</sup>

0 0,5 1,0 2,0 3,0 4,0 5,0 m