

2. KAT - STAN 41

3.41.1.	hodnik	pp	6,78 m ²
3.41.2.	kuhinja	pkp	4,95 m ²
3.41.3.	boravak i blagovanje	pp	17,26 m ²
3.41.4.	soba	pp	10,79 m ²
3.41.5.	kupaonica	pkp	3,57 m ²
3.41.6.	loggia	pkp	3,71 x 0,75 = 2,78 m ²
UKUPNO NETTO : 46,13 M²			

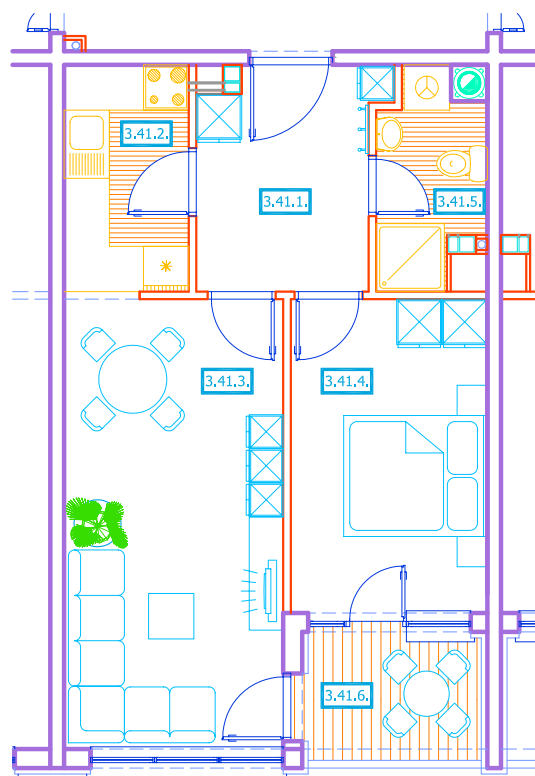

0 0,5 1,0 2,0 3,0 4,0 5,0 m