

4. KAT - STAN 66		
5.66.1.	hodnik	pp
	7,40 m ²	
5.66.2.	soba	pp
	13,95 m ²	
5.66.3.	boravak i blagovanje	pp
	24,64 m ²	
5.66.4.	kuhinja	pkp
	5,80 m ²	
5.66.5.	soba	pp
	17,89 m ²	
5.66.6.	kupaonica	pkp
	9,19 m ²	
5.66.7.	WC	pkp
	2,19 m ²	
5.66.8.	loggia	pkp
	4,19 x 0,75 = 3,14 m ²	
UKUPNO NETTO : 84,20 M²		

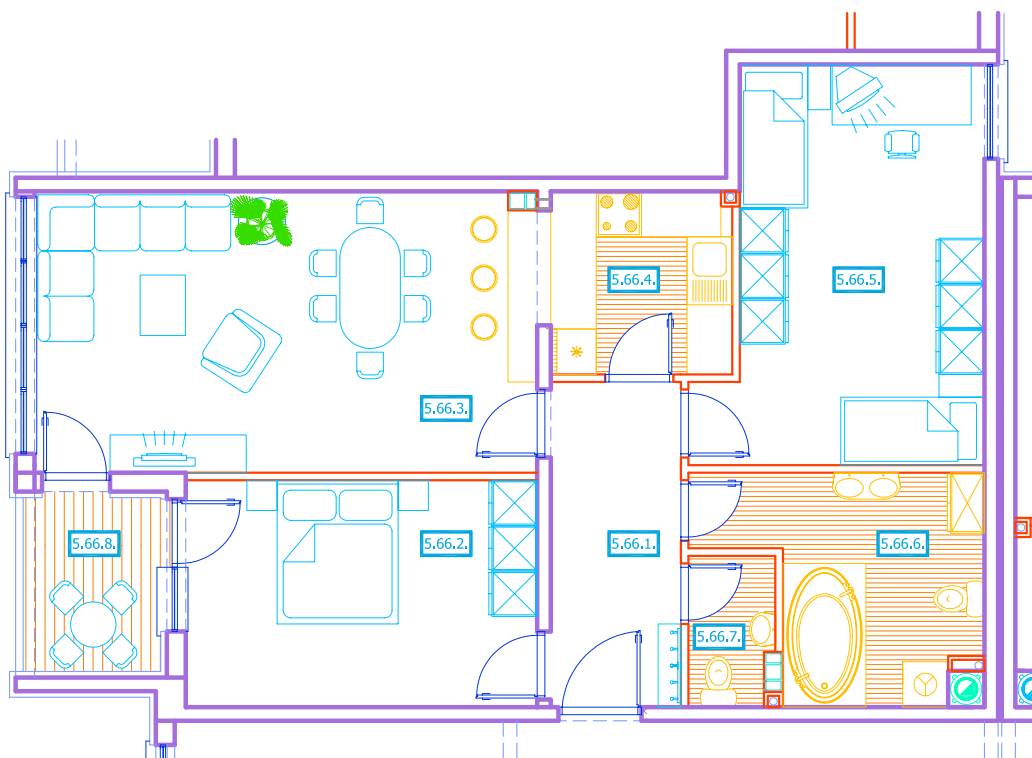

0 0,5 1,0 2,0 3,0 4,0 5,0 m